

Installation

- 1) Place the provided wood template on the wall where you want to mount the Fusion Frame Slim soundbar. Level the template and secure to the wall with screws using the provided holes located on the far left and right hand sides of the template.

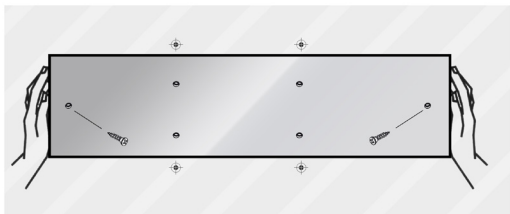

- 2) Trace around the outside of the template with a pencil, as well as make four small marks above and below the four holes located towards the center of the template on the wall. Keep the four marks as close to the template as possible.

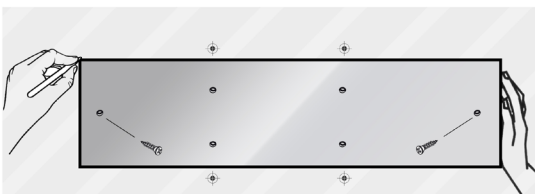

- 3) Remove the template and cutout the drywall located in the center of the rectangle created by tracing the template.

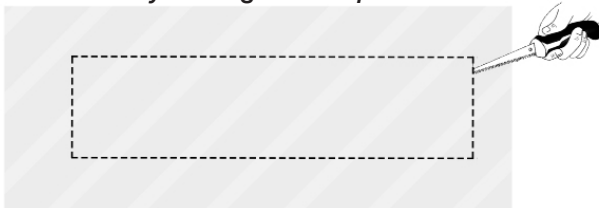

- 4) Mount the provided wood supports with the 1" #8 screws behind the wall in the locations marked on the wall. If there is a stud where you have marked the drywall you will use the stud to mount the soundbar instead of the wood support.

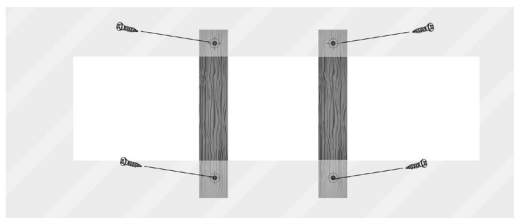

VERY IMPORTANT: When mounting the wood supports behind the drywall keep the screws as close as possible to the cutout opening. No more than 7/16" away from the opening or the 1/2" collar that goes around the soundbar will not cover over the screw heads.

Installation

- 5) Remove the grille from the soundbar and set aside
- 6) Wire the soundbar to the speaker terminals located on the back of the soundbar
- 7) Apply the foam gasket tape to the back edge of the speaker collar where it makes contact with the wall surface creating an isolation buffer.

- 8) Place the soundbar into the wall cavity

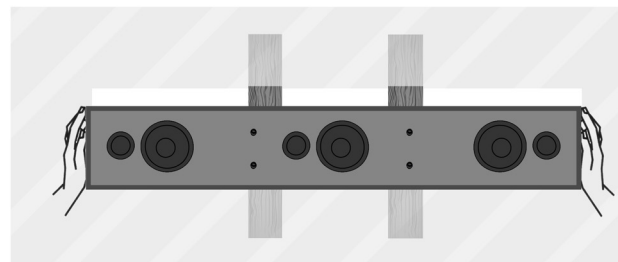

- 9) Secure the soundbar to the wall by driving the four 3" long screws through the four holes located on the front of the soundbar into either the wood supports or studs located behind the wall. You may loosen the screws in order to make micro-adjustments for leveling purposes.

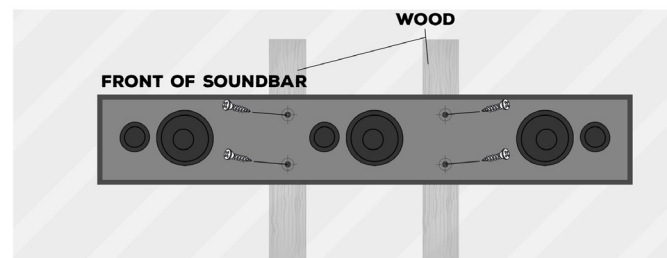

- 10) Replace the speaker grill.